

MODEL: M200-102-18-i133.2-B48V-AC96\_EC8  
 SUPPLY: 96V<sub>DC</sub> / 250A<sub>RMS</sub>

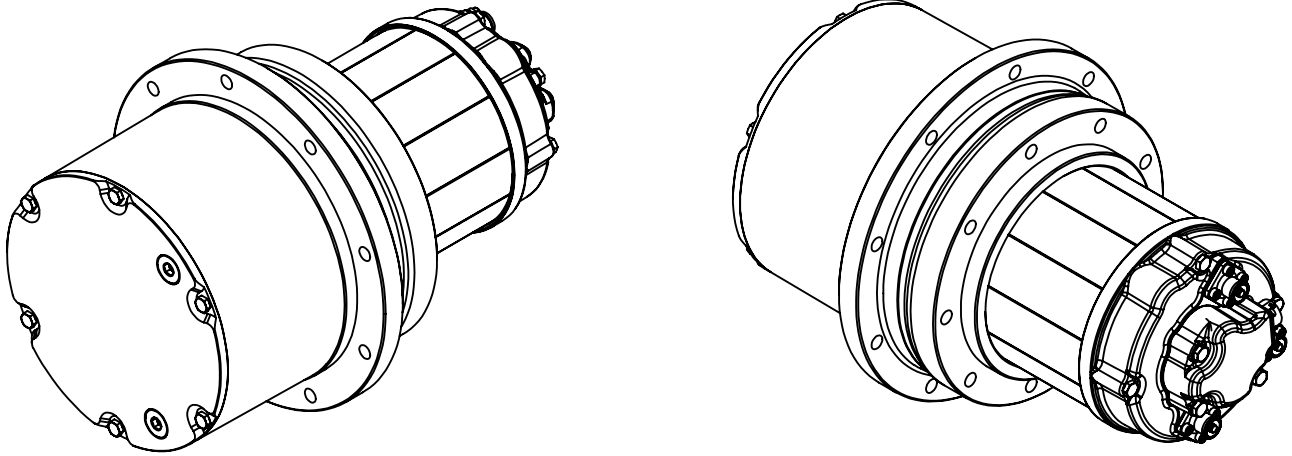

## DRIVE PERFORMANCE

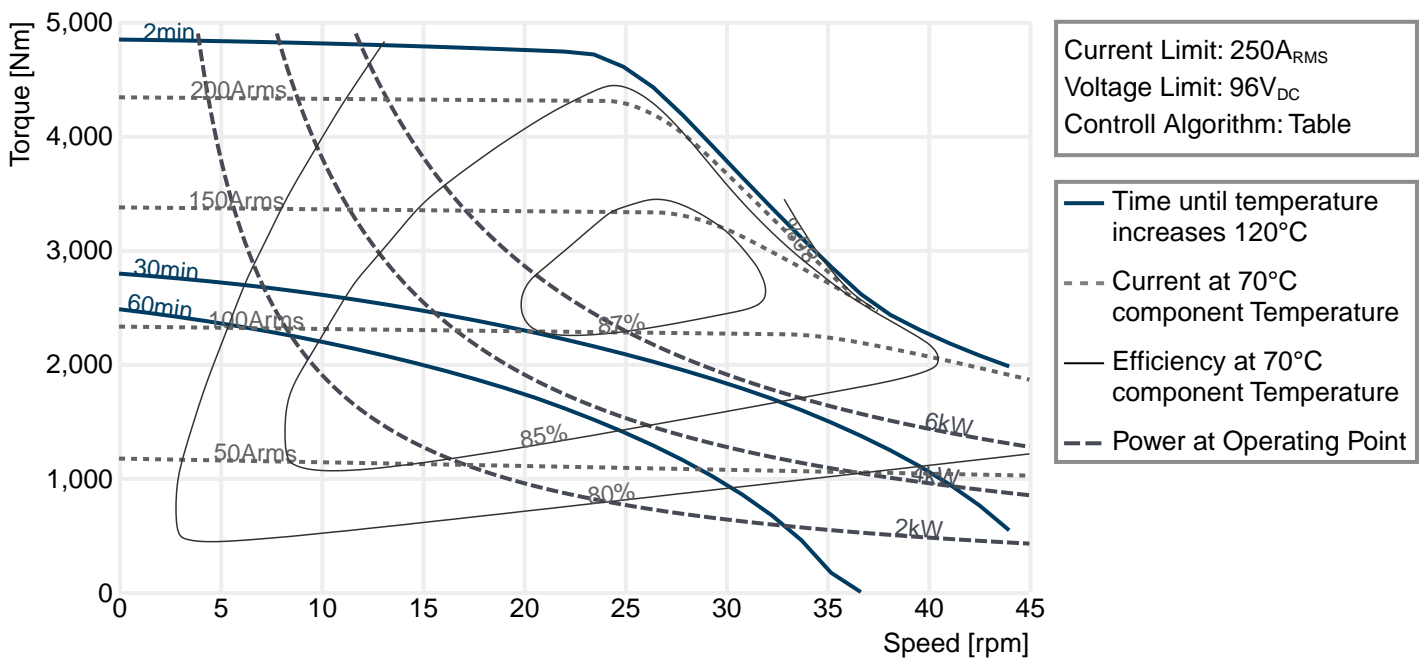

Engine Type	IPM	
Number of Poles	8	
Reducer Ratio	133.20	
Peak Torque (Flange)	4906 Nm	
Peak Current	224 Arms	
Torque Constant (Shaft / Flange)	0.16 Nm/Arms	21.0 Nm/Arms
Back EMF Const. (Line to Line @ motor shaft)	PEAK: 13.5 V/1000min-1	RMS: 9.5 V/1000min-1
Electrical Resistance @ 25°C	6 mOHM	
Electrical Inductance	Lq: 202 μH	Ld: 174 μH

## BRAKE

Brake Type	Negative Type Electric Disk Brake
Function Principle	Braked Engine Shaft
Nominal Voltage	48VDC
Typ. Braking Torque	4906 Nm
Typ. Resistance	37 OHM
Brake Type	Negative Type Electric Disk Brake

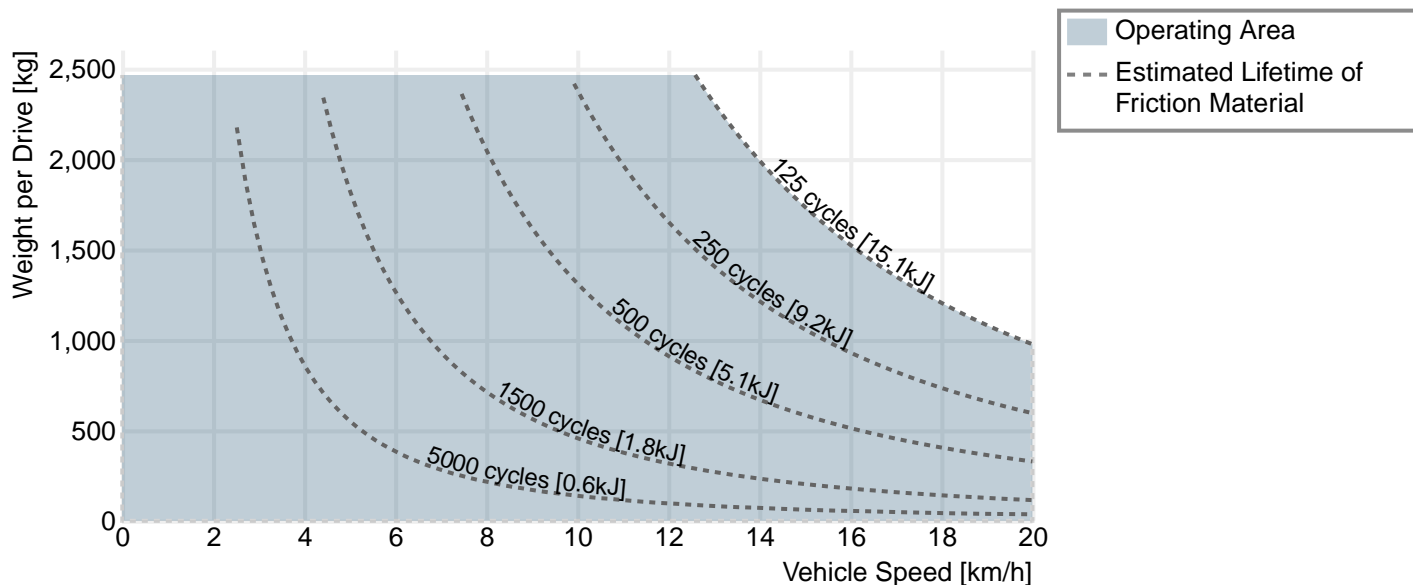

The number of possible cycles has been evaluated with flywheel-tests. The number of possible cycles in the real application will also depend on the inclination. The condition of the brake must be checked in the application

**DIMENSIONS**

SIDE VIEW

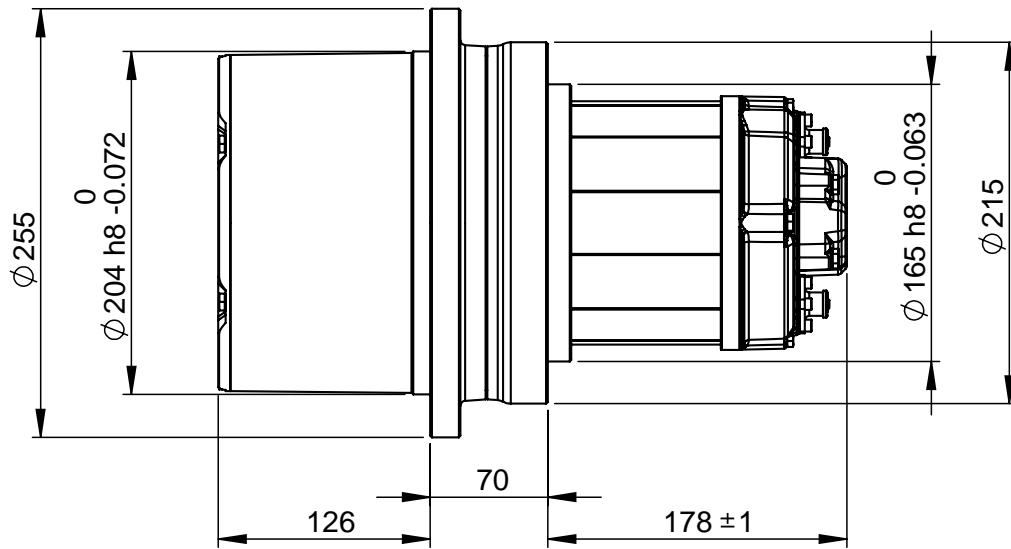

ROTATING FLANGE

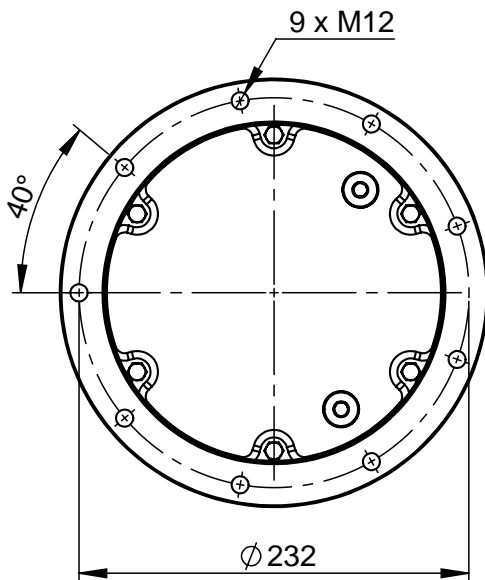

FIXED FLANGE

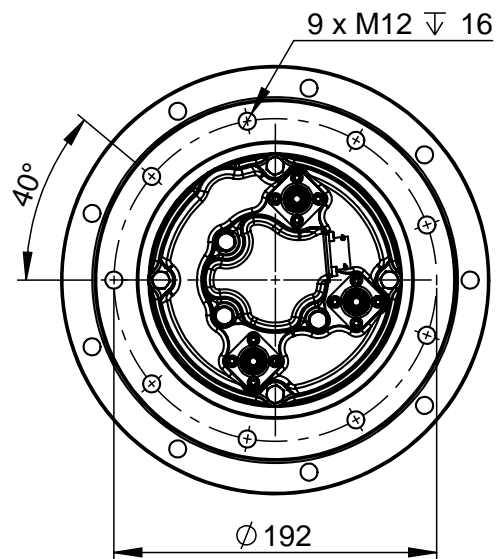

## SENSOR

Analogue sinusoidal Output

Power supply	Vdd = 5 V $\pm$ 5 %
Current consumption	Max. 30 mA
Internal serial impedance	100 OHM
Signal amplitude	2.2 $\pm$ 0.2 V <sub>pp</sub>
Signal offset	2.5 V $\pm$ 1 %

Timing Diagram

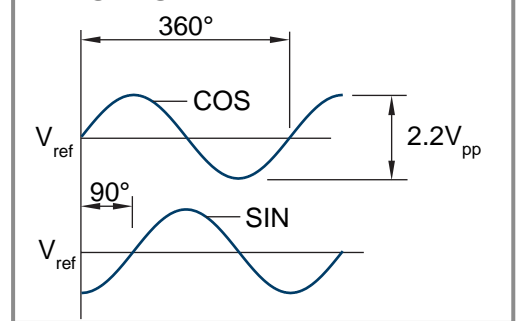

## TEMPERATURE SENSOR

Sensor Type	PT1000
Number of Sensors	1x
Position of Temperature Sensor	Encapsulated between stator winding

Table of the Resistance values:

-40 °C	843 OHM	60 °C	1232 OHM
-30 °C	882 OHM	70 °C	1271 OHM
-20 °C	922 OHM	80 °C	1309 OHM
-10 °C	961 OHM	90 °C	1347 OHM
0 °C	1000 OHM	100 °C	1385 OHM
10 °C	1039 OHM	110 °C	1423 OHM
20 °C	1078 OHM	120 °C	1461 OHM
30 °C	1117 OHM	130 °C	1498 OHM
40 °C	1155 OHM	140 °C	1536 OHM
50 °C	1194 OHM	150 °C	1573 OHM
60 °C	1232 OHM	160 °C	1611 OHM

## CONNECTIONS

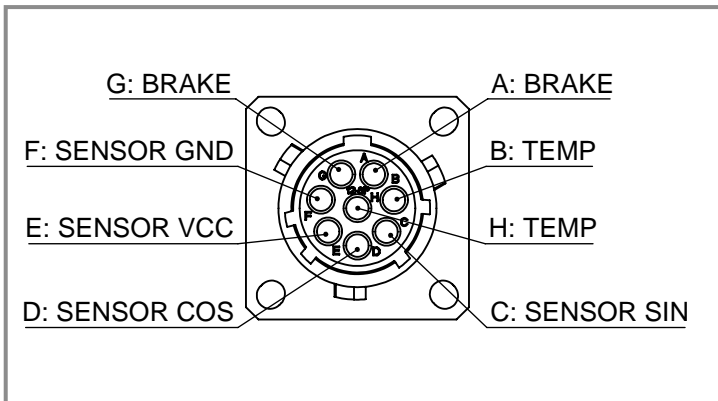
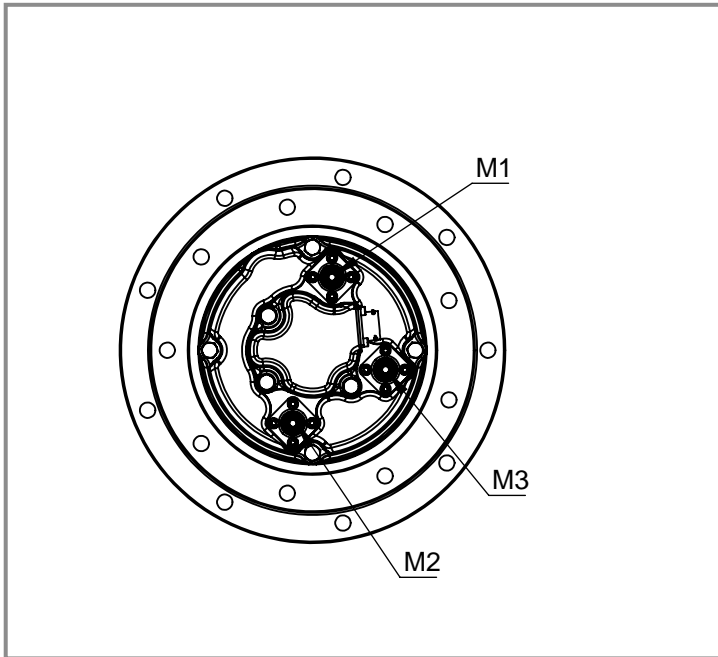



### Mating Power Connectors

	Part	Surlock Plus 5.7mm (16mm <sup>2</sup> )
	Mfg #	SLPPA16BSO
	I&W #	P0052_0013
	Mfg	Amphenol

	Part	Surlock Plus 5.7mm (25mm <sup>2</sup> )
	Mfg #	SLPPA25BSO
	I&W #	P0052_0014
	Mfg	Amphenol

### Mating Signal Connectors

	Part	Ecomate RM Plug
	Mfg #	RT06128SNH
	I&W #	P0052_0008
	Mfg	Amphenol

	Part	Socket Contact
	Mfg #	SS20W1F or SS20W2F
	I&W #	-
	Mfg	Amphenol

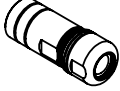
	Part	Backshell
	Mfg #	RT0L-12CG-S1
	I&W #	P0052_0010
	Mfg	Amphenol